

RetroFit Installation Manual

The following is a guideline on how to install Gauzy RetroFit Film. RetroFit film allows any existing window to instantly become LCG ®. Defined by a scratch proof coating for durability, and a wet adhesive PSA (in partnership with Avery Denison), RetroFit provides the benefits of smart glass with less commitment.

In addition to this written manual, please watch the complete Retrofit Installation Video Tutorial available on YouTube:

<https://www.youtube.com/watch?v=PclbqHWIRNs>

Required Items

Installation Tools:

- Squeegee
- Heavy Duty Squeegee
- Hard Card
- Paper Towels
- Disposable Plastic Syringe
- Johnson's Baby Shampoo
- Spray bottle

Electrical Tools:

- Controllers
- Electrical Plug
- Soldering Iron
- Touch Panel
- Electrical Leads



Package Opening and Handling

- Carefully remove film and lay flat
- Lay the film flat on a clean surface. You may use the foam and cardboard from original packaging.
- Do not bend or roll or the film. Film should always be held straight by the corner.

Preparing the Gauzy Controller:

Connectors may come attached or unattached.

For easiest wiring, we recommend attaching wires to connectors while NOT attached,

- Connect wires to "Ground", "Neutral" and "Line" and later secure connector back to the control box.
- Connect the film wires to "Out 1" and "Out 2" and secure connector back to the control box.
- Connect the touch panel wires to "DT On/Off".

Film Operation Testing:

Film should be tested for electrical performance before installing. To test film operation:

- Connect "Out 1" to "Busbar 1".
- Connect "Out 2" to "Busbar 2".
- Use the switch to turn the film on and off.

Gauzy RetroFit LCG ® is compatible with the Gauzy Touch Panel or any off the shelf switch.



Pre-Installation:

Preparing the wet adhesive solution:

- Using the disposable syringe, add 4cc of Johnsons and Johnsons Baby Shampoo to 1 liter of water in the spray bottle.
- Shake the bottle to mix.
- Make sure the pump is on maximum pressure.
- When applying the wet adhesive solution to glass and film, use Mist Mode.

Checking the film fits:

- Before cleaning and installing the film, ensure the film fits the designated space with the busbars in the correct place.
- There will be a 1-2mm gap between the film and borders on all sides.

Cleaning the glass before installation:

- Spray the window with a standard glass cleaner or water.
- Using the glass scraper, remove any dust, dirt, or particles from the glass surface.
- Clean all the way to the corners.
- Spray the glass again with the glass cleaner or water, and use the squeegee to wipe away all excess liquid.

Installation:

Applying the film:

- Carefully remove the protective layer (starting at the top corner of the film) to expose the PSA (adhesive side).
- Spray the PSA (using "Mist Mode") with the Wet Adhesive Solution prepared earlier.
- Spray the film from a distance of 30cm – 40cm.
- Now spray the glass surface with the same Wet Adhesive Solution from the same distance.
- Place the film on the glass with the adhesive side touching the glass.
- The soapy solution will help to adjust as needed.
- Remember, there will be a 1-2mm space between the film and frame.
- Spray the film (hard coat side) with the Wet Adhesive Solution. This will help when smoothing the surface.

Removing Water:

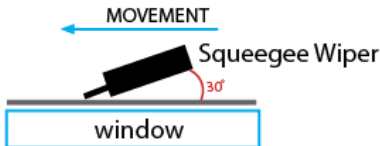
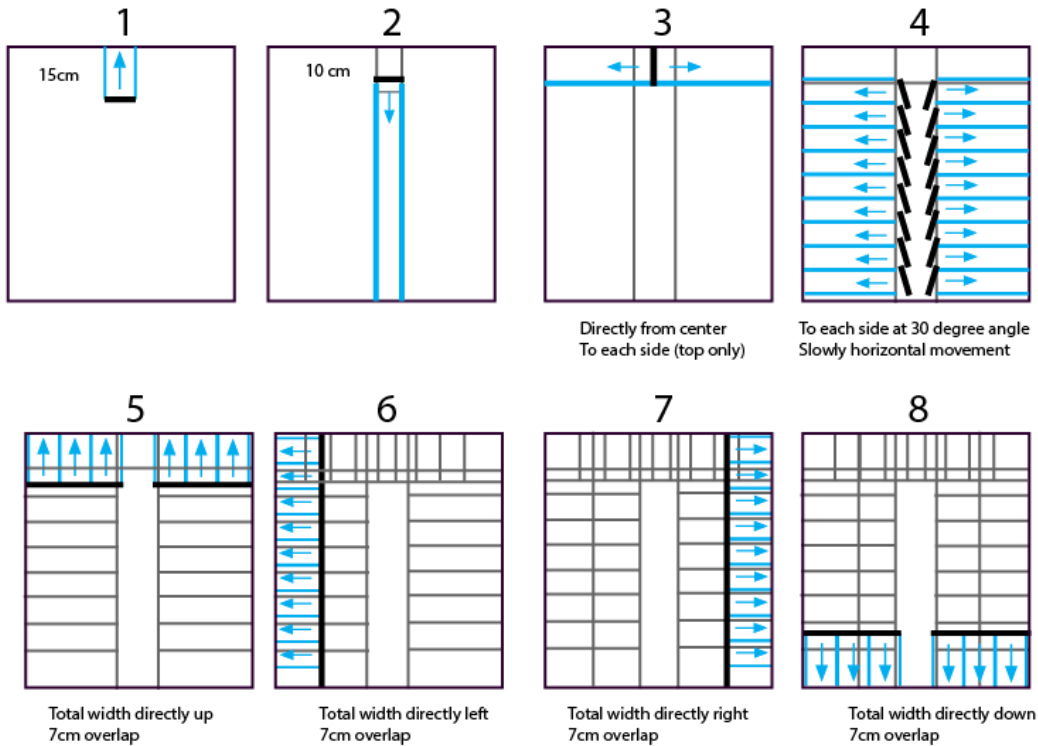

- Using the heavy-duty squeegee, apply a consistent steady and strong pressure while moving according to the directions in the above image. This pressure will push water in bubbles to the exit points (edges of film close to frame).
- This sequence ensures all areas of the glass are covered.

After completing the sequence:

- Wrap the heavy-duty squeegee in paper towel to absorb more water from edges.
- For final water absorption, wrap the hard card in paper towel, and using short swift movements to absorb final water from edges.



Electrical Preparation

Soldering and connecting wires can only take place 24 hours after installation so there is no water present when handling electricity.

- Solder the wires to the copper tails with a soldering iron.
 - First, solder "Out 1" to "Busbar 1"
 - Then, solder "Out 2" to "Busbar 2"
- We recommend placing a frame around all 4 sides to cover the, busbars, wires and gap between the window and frame.
- If silicon is required, please refer to the **Silicone Section** in the **General LCG ® Guidelines Manual** for a list of approved silicone products. This file is in the Downloads Section on the Gauzy website.

Operation

Install Gauzy Touch Panels according to the Touch Panel Installation Manuals available in the Downloads Section on the website.

Operate RetroFit LCG ® with a remote or touch panel.

For additional support, please contact:

support@gauzy.com